

# 3-BEDROOM

## TYPE C1

78 sqm / 840 sqft

(Inclusive of 5 sqm Balcony)

- Blk 45 #02-12 - #14-12
- Blk 47 #02-16 - #14-16
- Blk 57 #02-34 - #14-34
- Blk 59 #03-40 - #14-40
- Blk 61 #02-44 - #14-44
- Blk 63 #02-48 - #14-48

### MIRROR UNIT

- Blk 45 #02-09 - #14-09
- Blk 47 #02-13 - #14-13
- Blk 57 #02-35 - #14-35
- Blk 59 #03-37 - #14-37
- Blk 61 #02-41 - #14-41
- Blk 63 #02-45 - #14-45



## TYPE C1(p)

78 sqm / 840 sqft

(Inclusive of 5 sqm PES)

- Blk 45 #01-12
- Blk 47 #01-16
- Blk 57 #01-34
- Blk 61 #01-44
- Blk 63 #01-48

### MIRROR UNIT

- Blk 45 #01-09
- Blk 47 #01-13
- Blk 57 #01-35
- Blk 61 #01-41
- Blk 63 #01-45

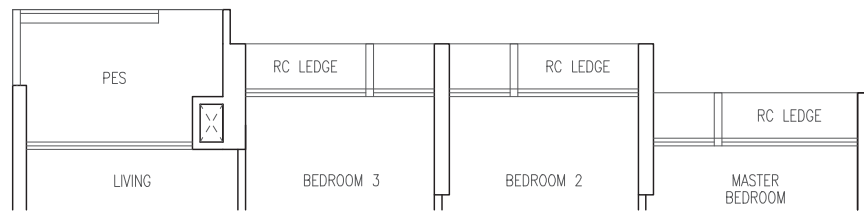

#### LEGEND

- F : Fridge (Not Included)
- WD : Washer Cum Dryer
- HS : Household Shelter
- DB / ST : Distribution Board / Storage
- RC Ledge : Reinforced Concrete Ledge (Non-strata)
- AC Ledge : Air Conditioner Ledge (Non-strata)

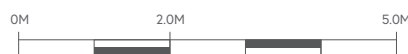

Area includes balcony and private enclosed space (PES) where applicable. All RC ledges and AC ledges are excluded from strata area and are non-load bearing. Some units are mirror images of the floor plans shown in the brochure. Orientations and facings will differ depending on the unit you are purchasing, please refer to the key plan. The above plans and illustrations are subject to changes as may be required or approved by the relevant authorities and do not form part of any offer or contract. Areas are estimates only and are subject to final survey. The balcony & PES shall not be enclosed unless with the approved balcony screen. For an illustration of the approved balcony screen, please refer to Annex A of this brochure.

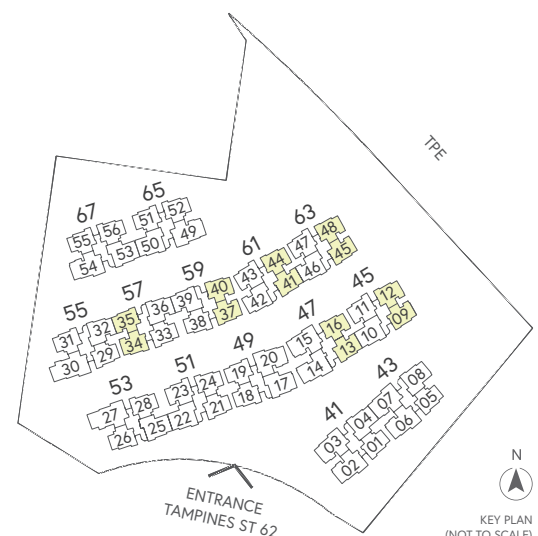



### TYPE C2P

81 sqm / 872 sqft

(Inclusive of 5 sqm Balcony)

- Blk 41 #02-01 - #14-01
- Blk 43 #02-05 - #14-05
- Blk 49 #03-19 - #14-19
- Blk 51 #03-21 - #14-21
- Blk 55 #02-29 - #14-29
- Blk 55 #02-31 - #14-31
- Blk 57 #02-33 - #14-33
- Blk 65 #02-51 - #14-51
- Blk 67 #02-55 - #14-55

#### MIRROR UNIT

- Blk 49 #03-18 - #14-18
- Blk 51 #03-24 - #14-24
- Blk 53 #02-26 - #14-26
- Blk 53 #02-28 - #14-28
- Blk 59 #03-38 - #14-38
- Blk 65 #02-52 - #14-52
- Blk 67 #02-56 - #14-56

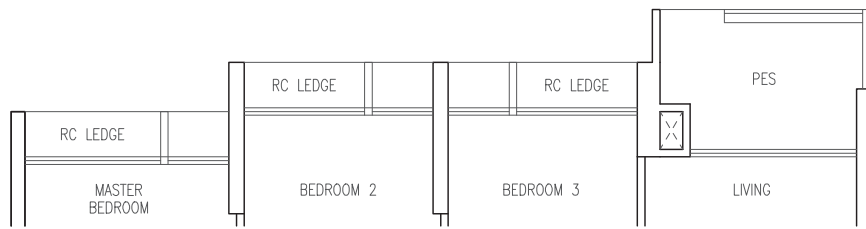

### TYPE C2P(p)

81 sqm / 872 sqft

(Inclusive of 5 sqm PES)

- Blk 41 #01-01
- Blk 55 #01-29
- Blk 55 #01-31
- Blk 57 #01-33
- Blk 65 #01-51
- Blk 67 #01-55

#### MIRROR UNIT

- Blk 53 #01-28
- Blk 65 #01-52
- Blk 67 #01-56

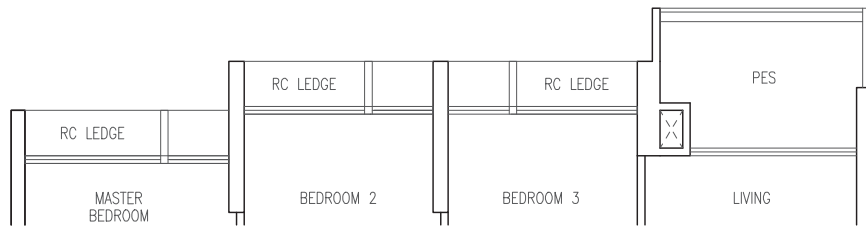

- Blk 43 #01-05

#### MIRROR UNIT

- Blk 53 #01-26

#### LEGEND

- F : Fridge (Not Included)
- WD : Washer Cum Dryer
- HS : Household Shelter
- WC : Water Closet
- DB / ST : Distribution Board / Storage
- RC Ledge : Reinforced Concrete Ledge (Non-strata)
- AC Ledge : Air Conditioner Ledge (Non-strata)



Area includes balcony and private enclosed space (PES) where applicable. All RC ledges and AC ledges are excluded from strata area and are non-load bearing. Some units are mirror images of the floor plans shown in the brochure. Orientations and facings will differ depending on the unit you are purchasing, please refer to the key plan. The above plans and illustrations are subject to changes as may be required or approved by the relevant authorities and do not form part of any offer or contract. Areas are estimates only and are subject to final survey. The balcony & PES shall not be enclosed unless with the approved balcony screen. For an illustration of the approved balcony screen, please refer to Annex A of this brochure.



# 3-BEDROOM + STUDY

## TYPE C3S

86 sqm / 926 sqft  
(Inclusive of 6 sqm Balcony)

- Blk 45 #02-11 - #14-11
- Blk 51 #03-23 - #14-23
- Blk 61 #02-43 - #14-43
- Blk 63 #02-47 - #14-47



## TYPE C3S(p)

86 sqm / 926 sqft  
(Inclusive of 6 sqm PES)

- Blk 45 #01-11
- Blk 61 #01-43
- Blk 63 #01-47

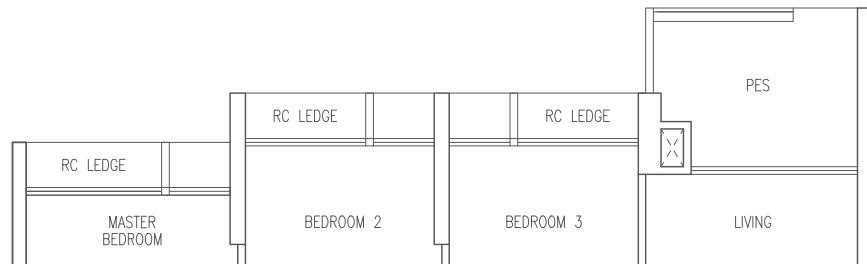

### LEGEND

- F : Fridge (Not Included)
- WD : Washer Cum Dryer
- HS : Household Shelter
- WC : Water Closet
- DB / ST : Distribution Board / Storage
- RC Ledge : Reinforced Concrete Ledge (Non-strata)
- AC Ledge : Air Conditioner Ledge (Non-strata)

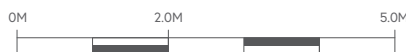

Area includes balcony and private enclosed space (PES) where applicable. All RC ledges and AC ledges are excluded from strata area and are non-load bearing. Some units are mirror images of the floor plans shown in the brochure. Orientations and facings will differ depending on the unit you are purchasing, please refer to the key plan. The above plans and illustrations are subject to changes as may be required or approved by the relevant authorities and do not form part of any offer or contract. Areas are estimates only and are subject to final survey. The balcony & PES shall not be enclosed unless with the approved balcony screen. For an illustration of the approved balcony screen, please refer to Annex A of this brochure.

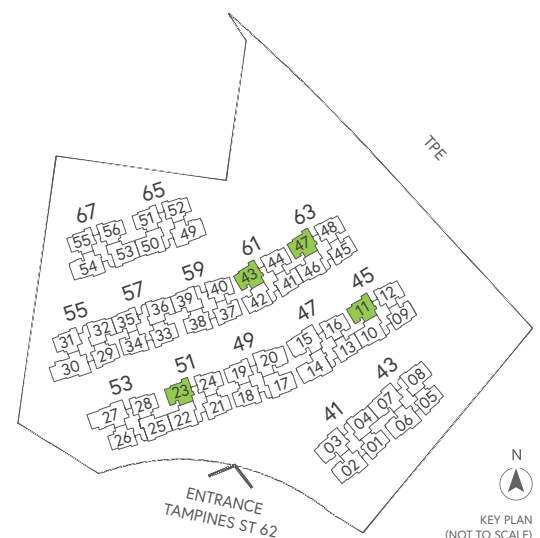

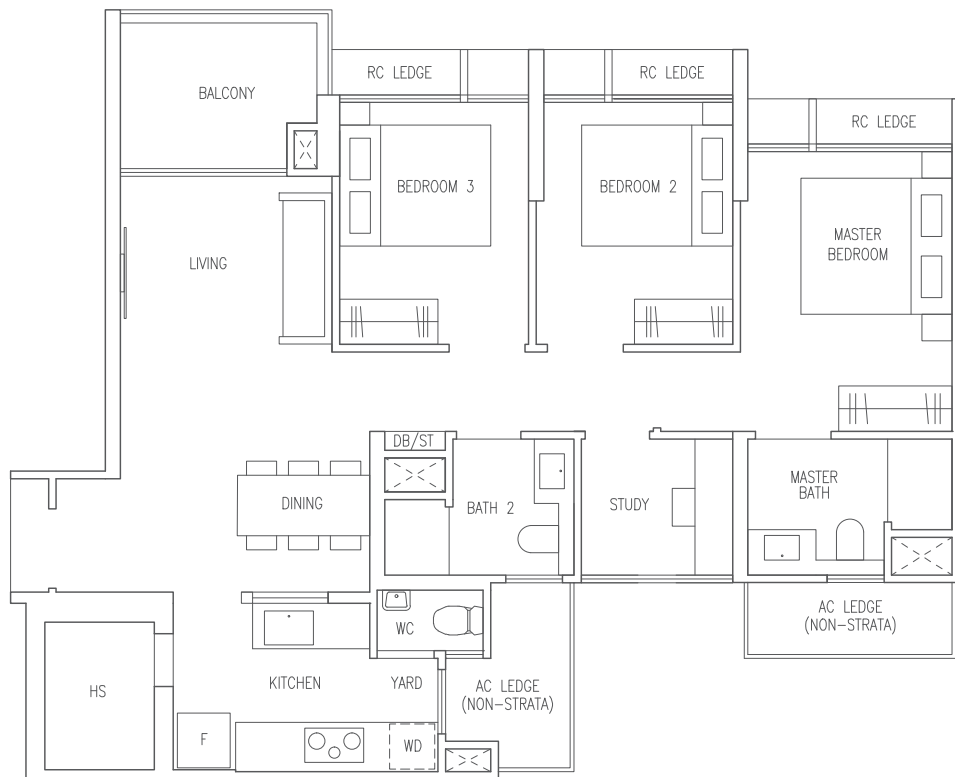

### TYPE C4S

88 sqm / 947 sqft  
(Inclusive of 6 sqm Balcony)

- Blk 55 #02-32 - #14-32
- Blk 57 #02-36 - #14-36
- Blk 61 #02-42 - #14-42
- Blk 63 #02-46 - #14-46

### MIRROR UNIT

- Blk 59 #03-39 - #14-39

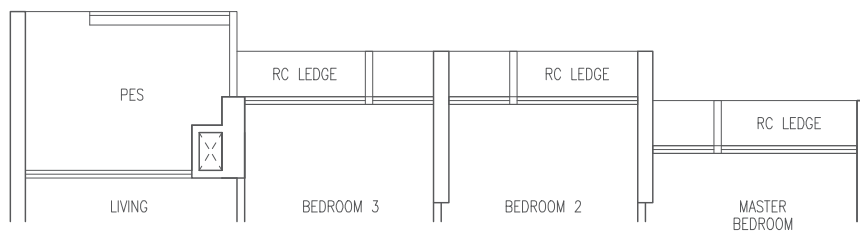

### TYPE C4S(p)

88 sqm / 947 sqft  
(Inclusive of 6 sqm PES)

- Blk 55 #01-32
- Blk 57 #01-36
- Blk 61 #01-42
- Blk 63 #01-46

#### LEGEND

- F : Fridge (Not Included)
- WD : Washer Cum Dryer
- HS : Household Shelter
- WC : Water Closet
- DB / ST : Distribution Board / Storage
- RC Ledge : Reinforced Concrete Ledge (Non-strata)
- AC Ledge : Air Conditioner Ledge (Non-strata)

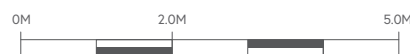

Area includes balcony and private enclosed space (PES) where applicable. All RC ledges and AC ledges are excluded from strata area and are non-load bearing. Some units are mirror images of the floor plans shown in the brochure. Orientations and facings will differ depending on the unit you are purchasing, please refer to the key plan. The above plans and illustrations are subject to changes as may be required or approved by the relevant authorities and do not form part of any offer or contract. Areas are estimates only and are subject to final survey. The balcony & PES shall not be enclosed unless with the approved balcony screen. For an illustration of the approved balcony screen, please refer to Annex A of this brochure.

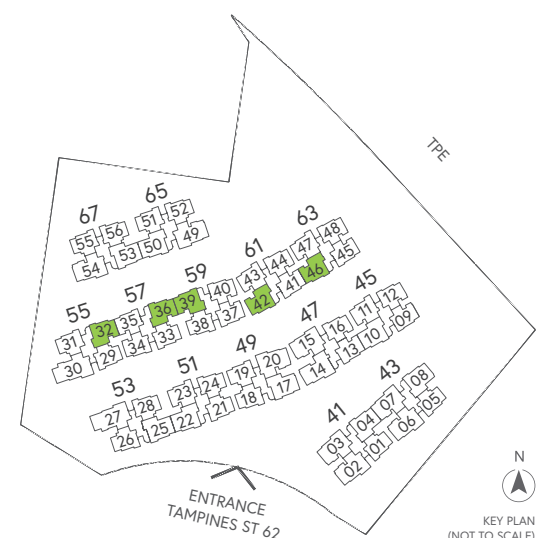

# 4-BEDROOM COMPACT

## TYPE D1

95 sqm / 1023 sqft

(Inclusive of 6 sqm Balcony)

- Blk 49 #03-17 - #14-17
- Blk 53 #02-25 - #14-25
- Blk 67 #02-53 - #14-53

### MIRROR UNIT

- Blk 41 #02-04 - #14-04
- Blk 43 #02-08 - #14-08
- Blk 45 #02-10 - #14-10
- Blk 51 #03-22 - #14-22
- Blk 65 #02-50 - #14-50

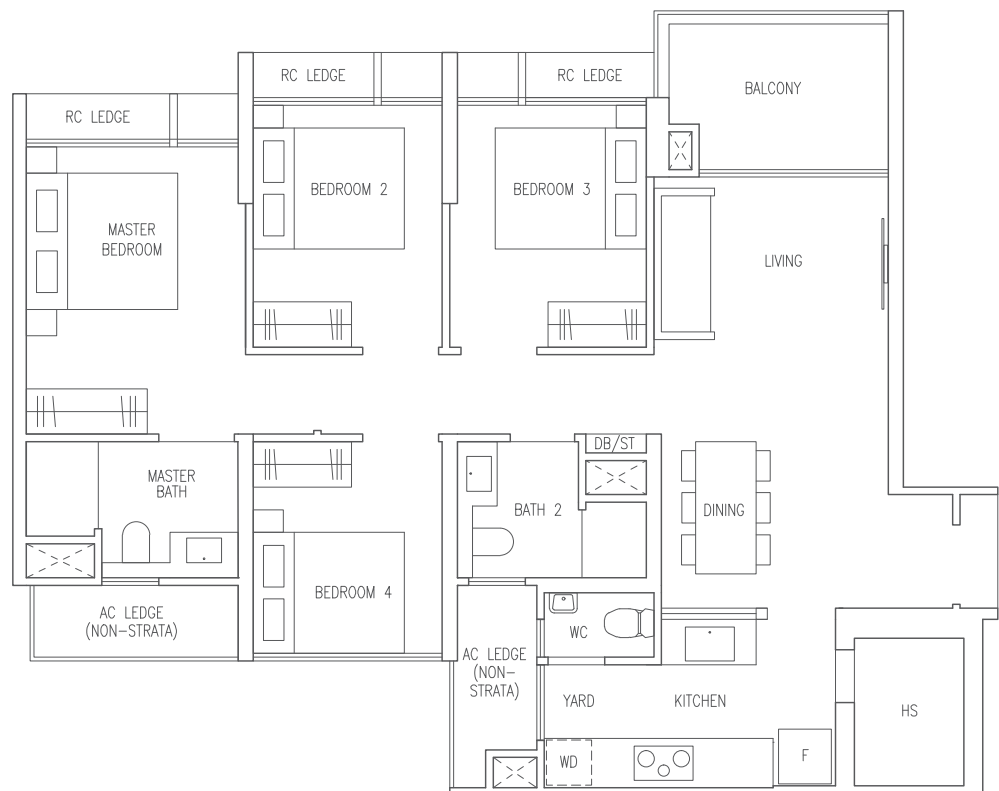

## TYPE D1(p)

95 sqm / 1023 sqft

(Inclusive of 6 sqm PES)

- Blk 67 #01-53

### MIRROR UNIT

- Blk 41 #01-04
- Blk 43 #01-08
- Blk 45 #01-10
- Blk 65 #01-50

- Blk 53 #01-25

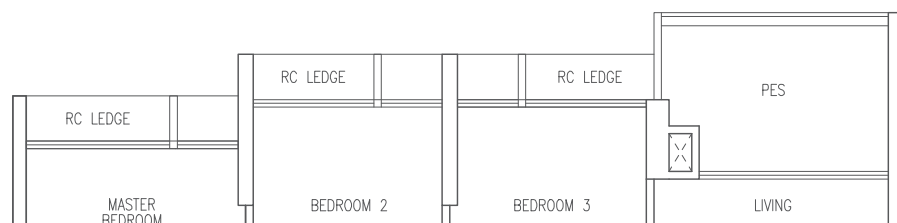
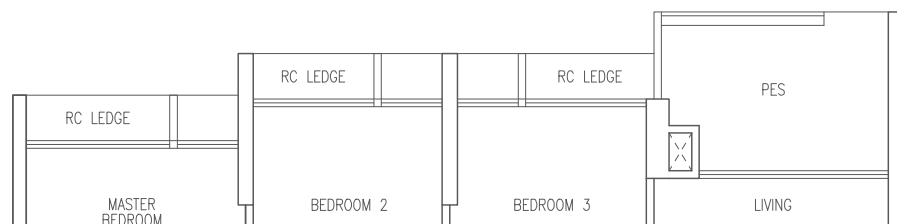

### LEGEND

- F : Fridge (Not Included)
- WD : Washer Cum Dryer
- HS : Household Shelter
- WC : Water Closet
- DB / ST : Distribution Board / Storage
- RC Ledge : Reinforced Concrete Ledge (Non-strata)
- AC Ledge : Air Conditioner Ledge (Non-strata)



Area includes balcony and private enclosed space (PES) where applicable. All RC ledges and AC ledges are excluded from strata area and are non-load bearing. Some units are mirror images of the floor plans shown in the brochure. Orientations and facings will differ depending on the unit you are purchasing, please refer to the key plan. The above plans and illustrations are subject to changes as may be required or approved by the relevant authorities and do not form part of any offer or contract. Areas are estimates only and are subject to final survey. The balcony & PES shall not be enclosed unless with the approved balcony screen. For an illustration of the approved balcony screen, please refer to Annex A of this brochure.

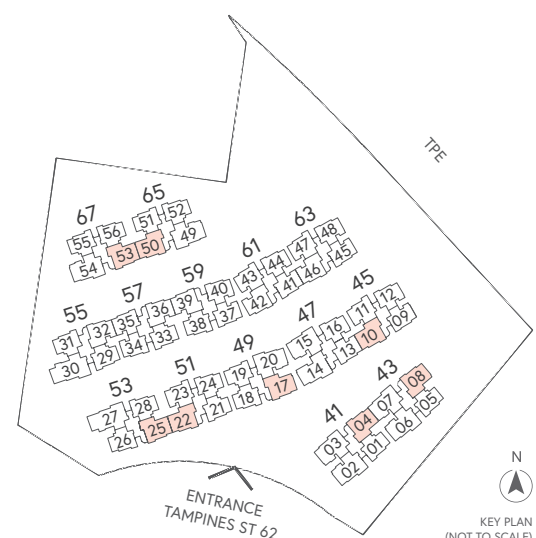

KEY PLAN  
(NOT TO SCALE)



### TYPE D2F

112 sqm / 1206 sqft  
(Inclusive of 11 sqm Balcony)

Blk 47 #02-14 - #14-14

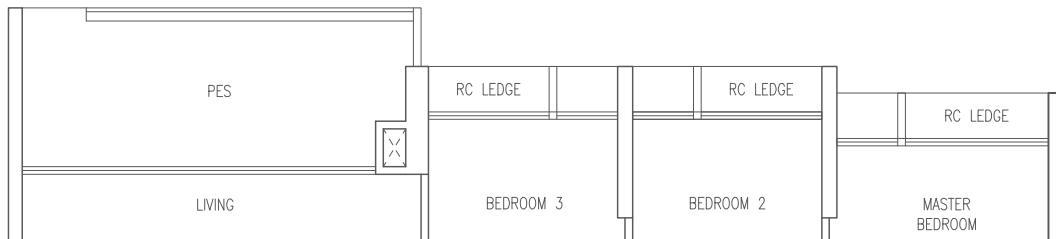

### TYPE D2F(p)

112 sqm / 1206 sqft  
(Inclusive of 11 sqm PES)

Blk 47 #01-14

**LEGEND**

- F : Fridge (Not Included)
- WD : Washer Cum Dryer
- HS : Household Shelter
- WC : Water Closet
- DB / ST : Distribution Board / Storage
- RC Ledge : Reinforced Concrete Ledge (Non-strata)
- AC Ledge : Air Conditioner Ledge (Non-strata)

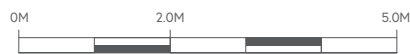

Area includes balcony and private enclosed space (PES) where applicable. All RC ledges and AC ledges are excluded from strata area and are non-load bearing. Some units are mirror images of the floor plans shown in the brochure. Orientations and facings will differ depending on the unit you are purchasing, please refer to the key plan. The above plans and illustrations are subject to changes as may be required or approved by the relevant authorities and do not form part of any offer or contract. Areas are estimates only and are subject to final survey. The balcony & PES shall not be enclosed unless with the approved balcony screen. For an illustration of the approved balcony screen, please refer to Annex A of this brochure.

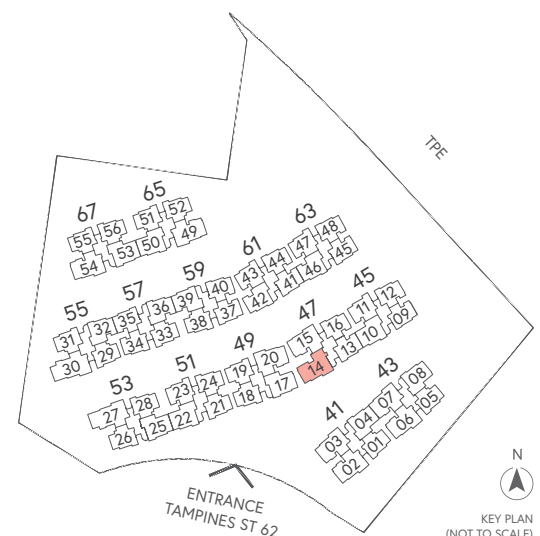

# 4-BEDROOM FLEXI

## TYPE D3F

111 sqm / 1195 sqft  
(Inclusive of 11 sqm Balcony)

Blk 47 #02-15 - #14-15

### MIRROR UNIT

Blk 49 #03-20 - #14-20



## TYPE D3F(p)

111 sqm / 1195 sqft  
(Inclusive of 11 sqm PES)

Blk 47 #01-15

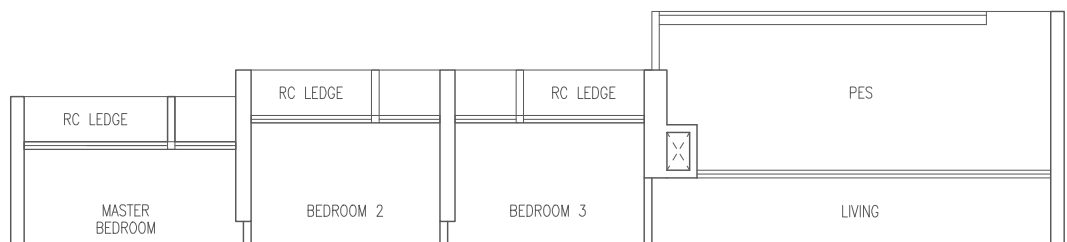

### LEGEND

- F : Fridge (Not Included)
- WD : Washer Cum Dryer
- HS : Household Shelter
- WC : Water Closet
- DB / ST : Distribution Board / Storage
- RC Ledge : Reinforced Concrete Ledge (Non-strata)
- AC Ledge : Air Conditioner Ledge (Non-strata)

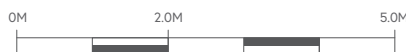

Area includes balcony and private enclosed space (PES) where applicable. All RC ledges and AC ledges are excluded from strata area and are non-load bearing. Some units are mirror images of the floor plans shown in the brochure. Orientations and facings will differ depending on the unit you are purchasing, please refer to the key plan. The above plans and illustrations are subject to changes as may be required or approved by the relevant authorities and do not form part of any offer or contract. Areas are estimates only and are subject to final survey. The balcony & PES shall not be enclosed unless with the approved balcony screen. For an illustration of the approved balcony screen, please refer to Annex A of this brochure.

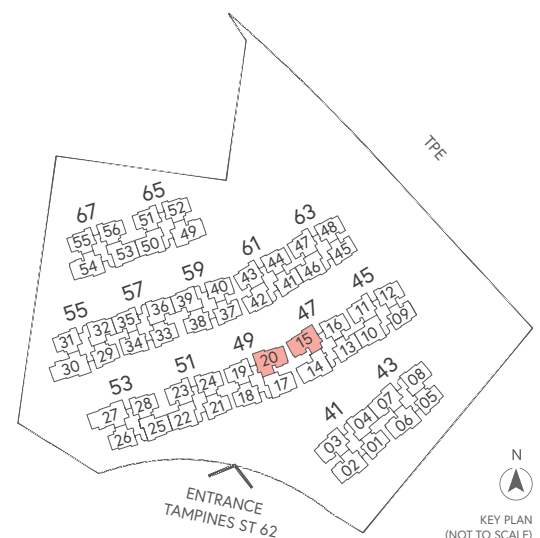



### TYPE D4P

112 sqm / 1206 sqft  
(Inclusive of 11 sqm Balcony)

- Blk 41 #02-02 - #14-02
- Blk 43 #02-06 - #14-06
- Blk 67 #02-54 - #14-54

#### MIRROR UNIT

- Blk 41 #02-03 - #14-03
- Blk 43 #02-07 - #14-07
- Blk 65 #02-49 - #14-49

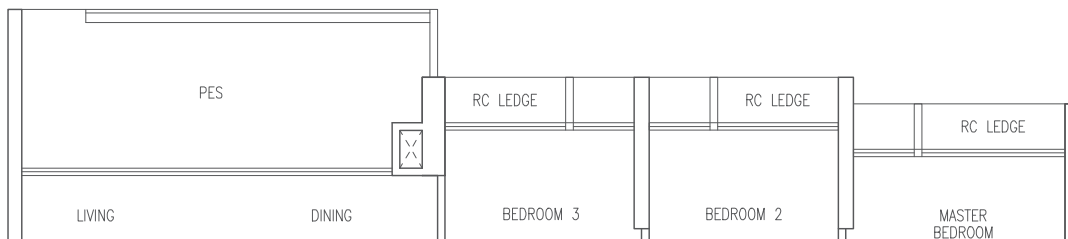

### TYPE D4P(p)

112 sqm / 1206 sqft  
(Inclusive of 11 sqm PES)

- Blk 41 #01-02
- Blk 67 #01-54

#### MIRROR UNIT

- Blk 41 #01-03
- Blk 43 #01-07
- Blk 65 #01-49

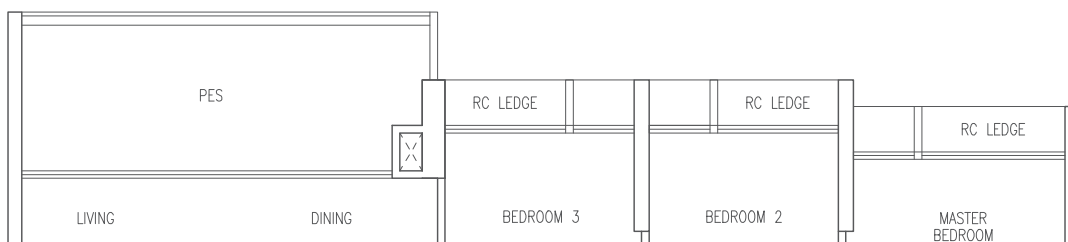

- Blk 43 #01-06

#### LEGEND

- F : Fridge (Not Included)
- WD : Washer Cum Dryer
- HS : Household Shelter
- WC : Water Closet
- DB / ST : Distribution Board / Storage
- RC Ledge : Reinforced Concrete Ledge (Non-strata)
- AC Ledge : Air Conditioner Ledge (Non-strata)

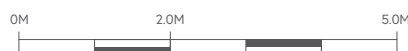

Area includes balcony and private enclosed space (PES) where applicable. All RC ledges and AC ledges are excluded from strata area and are non-load bearing. Some units are mirror images of the floor plans shown in the brochure. Orientations and facings will differ depending on the unit you are purchasing, please refer to the key plan. The above plans and illustrations are subject to changes as may be required or approved by the relevant authorities and do not form part of any offer or contract. Areas are estimates only and are subject to final survey. The balcony & PES shall not be enclosed unless with the approved balcony screen. For an illustration of the approved balcony screen, please refer to Annex A of this brochure.





# 5-BEDROOM

## TYPE E1

126 sqm / 1356 sqft

(Inclusive of 11 sqm Balcony)

### MIRROR UNIT

Blk 55 #02-30 - #14-30

Blk 53 #02-27 - #14-27



## TYPE E1(p)

126 sqm / 1356 sqft

(Inclusive of 11 sqm PES)

### MIRROR UNIT

Blk 55 #01-30

Blk 53 #01-27

#### LEGEND

- F : Fridge (Not Included)
- WD : Washer Cum Dryer
- HS : Household Shelter
- WC : Water Closet
- DB / ST : Distribution Board / Storage
- RC Ledge : Reinforced Concrete Ledge (Non-strata)
- AC Ledge : Air Conditioner Ledge (Non-strata)



Area includes balcony and private enclosed space (PES) where applicable. All RC ledges and AC ledges are excluded from strata area and are non-load bearing. Some units are mirror images of the floor plans shown in the brochure. Orientations and facings will differ depending on the unit you are purchasing, please refer to the key plan. The above plans and illustrations are subject to changes as may be required or approved by the relevant authorities and do not form part of any offer or contract. Areas are estimates only and are subject to final survey. The balcony & PES shall not be enclosed unless with the approved balcony screen. For an illustration of the approved balcony screen, please refer to Annex A of this brochure.

